

EVOLVE AUDIO SB-2500/2501 QUICK START GUIDE

1. PLACING & POWERING UP THE SOUNDBAR

- Place the soundbar in front of the TV or on a shelf.
- Locate the 12V adaptor and connect to the soundbar's 12V DC input. The label on the 12V DC jack is **BLUE**.
- Connect the AC cord to the mains power outlet
- Switch on the power switch on the back panel of the soundbar

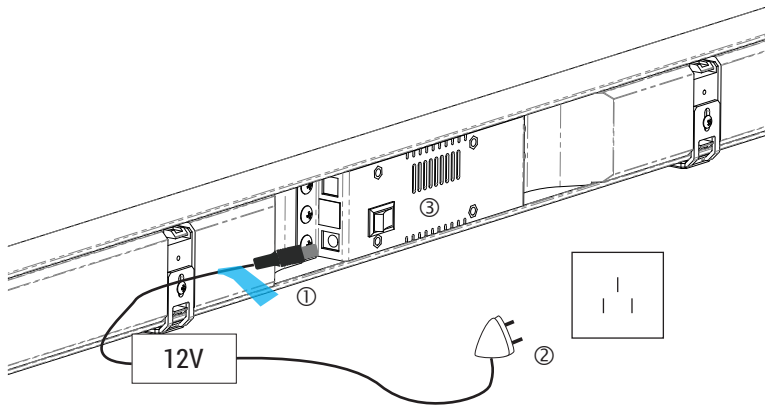

2. CONNECTING TO YOUR TELEVISION

Connect the optical cable provided from the optical output on the soundbar to the optical input on your tv (if you don't have an optical connection on your TV you can connect via either analogue RCA or 3.5mm mini-jack).

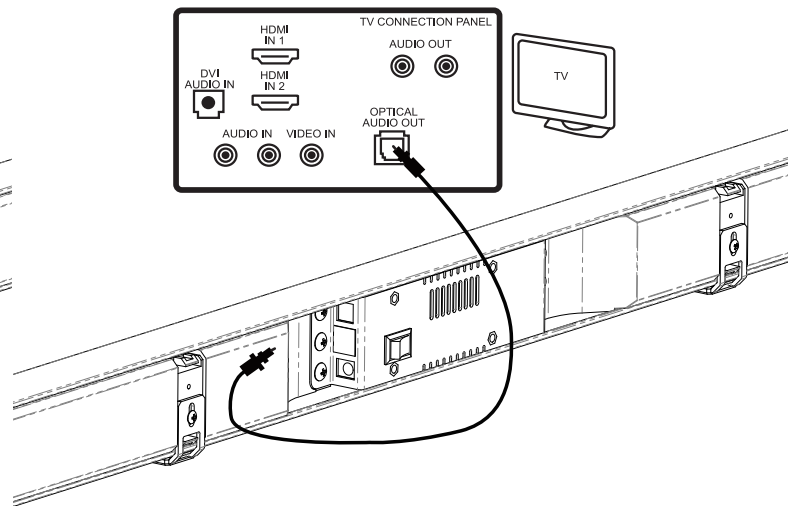

3. CONNECTING TO THE SUBWOOFER

- Locate the 15V adaptor and connect to the subwoofer's 15V DC input. The label on the 15V DC jack is **GREEN**.
- Connect the AC cord to the wall outlet
- Switch on the power switch on the back panel of the subwoofer.
- The wireless indicator on the soundbar control panel should stop blinking.
- If not, you will need to pair the subwoofer with the soundbar by following these steps.

- Hold the pairing button on the back panel of the subwoofer for 2 seconds.

- Press the pairing button on the control panel of the soundbar for two seconds.

- Once the pairing button LED switches off, the pairing process is completed.

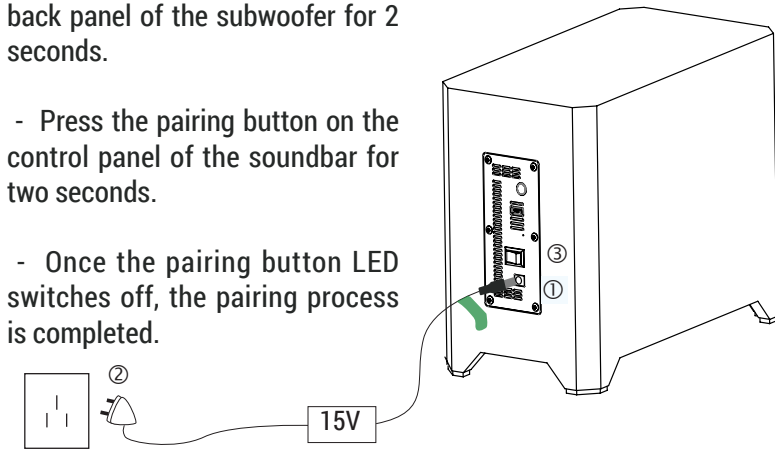

4. START USING THE SOUNDBAR

- Insert the battery into the battery compartment of the remote control.
- Press the power button on the remote to turn on the soundbar.
- Press the source button on the remote to select the input source.

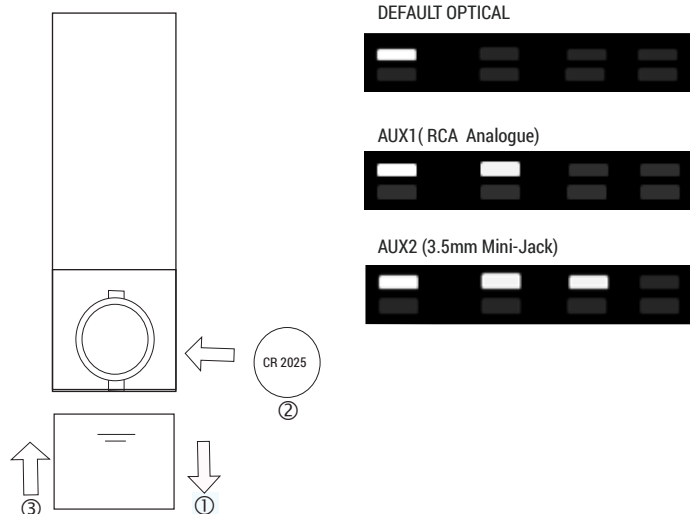

5. CONNECTING A BLUETOOTH DEVICE

- Press the  button on the remote or soundbar. This puts the soundbar into Bluetooth mode, there will then be a white flashing LED on the indicator panel of the soundbar.

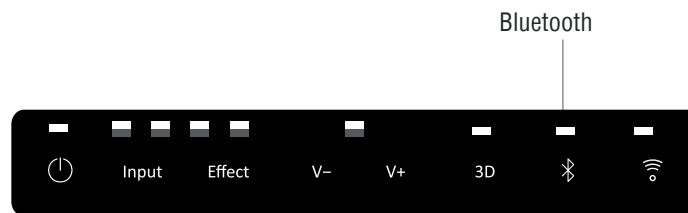

- You have to pair your Bluetooth device with the soundbar before you can stream music to it. Switch on the Bluetooth function which you normally find under 'SETTINGS' on your phone. Then search for Bluetooth devices.
- Once you have found 'Evolve SB-2500' select it and your device will pair with the soundbar. You are now ready to stream music from your Bluetooth device. For more information about Bluetooth, please refer to the Owner's Manual.

6. USING YOUR EVOLVE WIRELESS HEADPHONES

- Press the power button on the headphones to turn on. Once the headphones are connected the soundbar will automatically mute and sound will come through the headphones
- To switch back to the soundbar, simply turn off the headphones and press the **MUTE** button on the remote.
- If the headphones were not included in the box and you purchased them separately, you will need to pair the headphones before using them by following these steps.

- Turn on the headphones power by pressing the **power button**.

- Touch and hold the  on the soundbar control panel for 3 seconds.

- Once paired with the soundbar, the soundbar will mute and sound will come through the headphones.

